

- NOTES:
 1. SEE SHEET A2.1c FOR ALL PLAN SECTION VIEWS.
 2. SEE SHEET A2.1c FOR MODULE DIMENSION TOLERANCES.

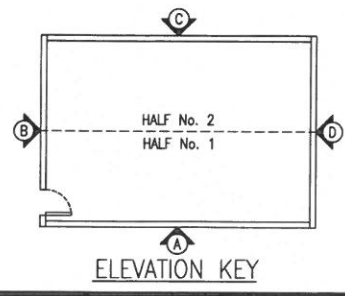

BY:	DATE	BLDG. & PROJ. NO.	ADDED-TO / REMOVED-FROM SET	APP.	DATE	REV.	BY	DATE	REVISION	ENG.	DATE	BOM.	DATE
						3	BW	04/14/06	REVISED CORNERPOST FOAM TO TURN DOWN 90°	BW	04/14/06	GS	04/14/06
						2	BW	02/10/06	RELEASED FOR PRODUCTION	BW	02/10/06	GS	02/10/06
						1	BW	01/27/06	RELEASED FOR PRINT REVIEW & B.O.M. GENERATION	BW	01/27/06		

THESE PLANS ARE THE CONFIDENTIAL PROPERTY AND TRADE SECRETS OF FIBREBOND CORPORATION. ANY USE OF THESE DRAWINGS OR THE INFORMATION CONTAINED HEREIN FOR ANY REASON OTHER THAN AS EXPRESSLY AUTHORIZED BY FIBREBOND CORPORATION IS STRICTLY PROHIBITED. THESE DRAWINGS HAVE BEEN DISTRIBUTED WITH THE UNDERSTANDING THAT ANY ONE RECEIVING OR OTHERWISE OBTAINING POSSESSION OF THEM WILL BE EXPRESSLY NOTIFIED OF THEIR CONFIDENTIAL NATURE.

FIBREBOND CORPORATION
 1300 Davenport Drive Minden, Louisiana 71055 800-824-2614

DRN. BY: BW DATE: 01/09/06
 CHK. BY: MT/RB DATE: 01/26/06
 APP. BY: BW DATE: 01/27/06
 ENG. BY: DATE:

FIBREBOND CORPORATION STANDARD TRANSPORTABLE CLASSROOM
 24'-0" X 32'-0" CLASSROOM MODULE
 FLOOR PLAN LAYOUT

SCALE: 1/4" = 1'-0" SHEET NO.: A2.1a DWG NO.: D-7817

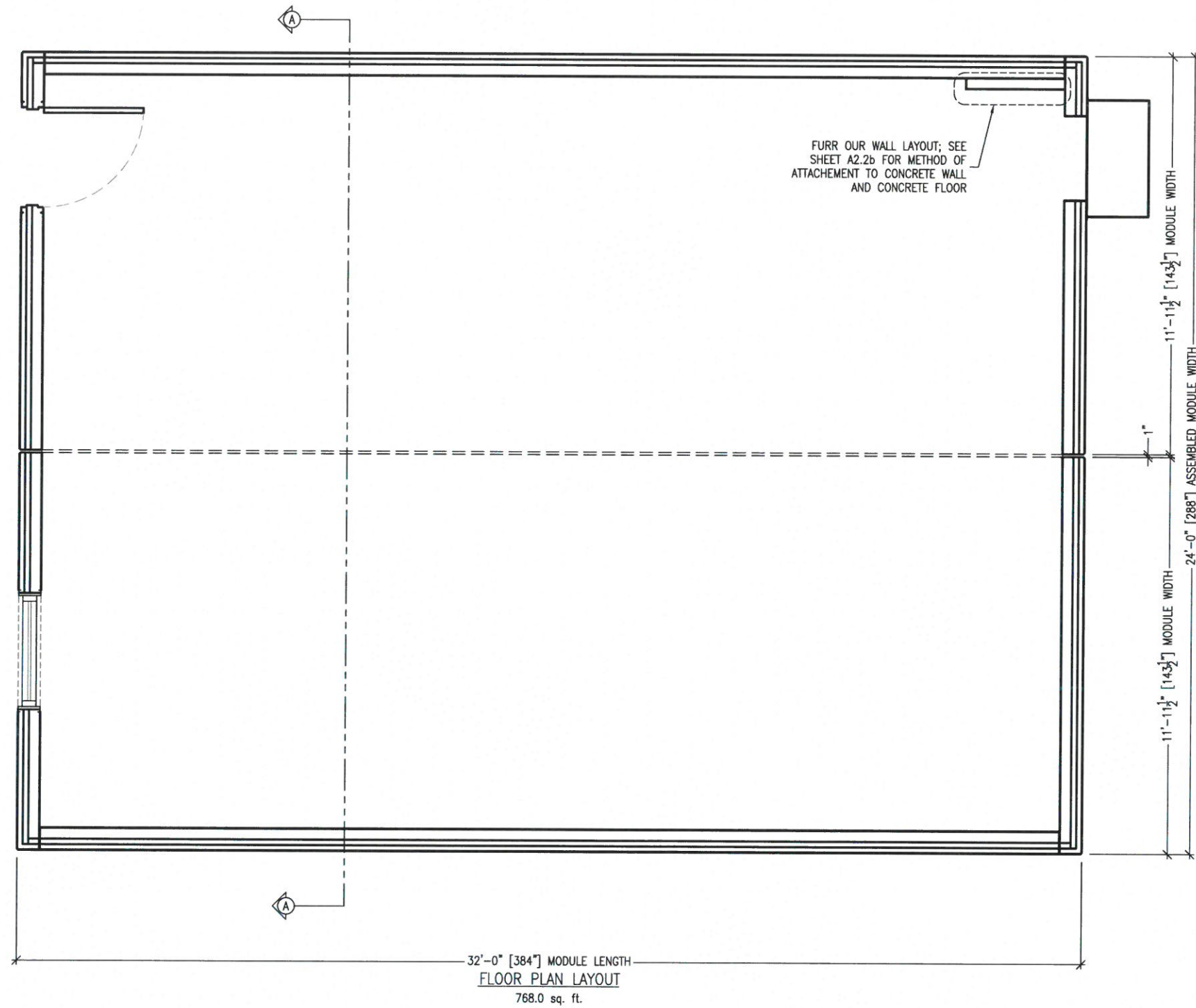

NOTES:

1. SEE SHEET A2.1c FOR ALL PLAN SECTION VIEWS.
2. SEE SHEET A2.1c FOR MODULE DIMENSION TOLERANCES.

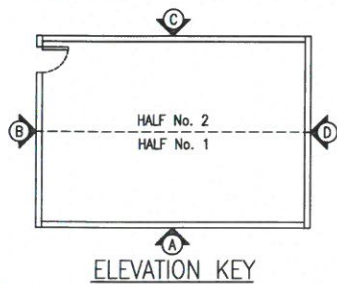

BY:	DATE	BLDG. & PROJ. NO.	ADDED-TO / REMOVED-FROM SET	APP.	DATE	REV.	BY	DATE	REVISION	ENG.	DATE	BOM.	DATE
						1	BW	01/27/06	RELEASED FOR PRINT REVIEW & B.O.M. GENERATION	BW	01/27/06		
						2	BW	02/10/06	RELEASED FOR PRODUCTION	BW	02/10/06	GS	02/10/06
						3	BW	04/14/06	REVISED CORNERPOST FOAM TO TURN DOWN 90°	BW	04/14/06	GS	04/14/06

THESE PLANS ARE THE CONFIDENTIAL PROPERTY AND TRADE SECRETS OF FIBREBOND CORPORATION. ANY USE OF THESE DRAWINGS OR THE INFORMATION CONTAINED HEREIN FOR ANY REASON OTHER THAN AS EXPRESSLY AUTHORIZED BY FIBREBOND CORPORATION IS STRICTLY PROHIBITED. THESE DRAWINGS HAVE BEEN DISTRIBUTED WITH THE UNDERSTANDING THAT ANY ONE RECEIVING OR OTHERWISE OBTAINING POSSESSION OF THEM WILL BE EXPRESSLY NOTIFIED OF THEIR CONFIDENTIAL NATURE.

FIBREBOND CORPORATION
1300 Davenport Drive Minden, Louisiana 71055 800-824-2614

DRN: BW DATE: 01/09/06
CHK: MT/RB DATE: 01/26/06
APP: BW DATE: 01/27/06
ENG: BY: DATE:

FIBREBOND CORPORATION STANDARD TRANSPORTABLE CLASSROOM
24'-0" X 32'-0" CLASSROOM MODULE
FLOOR PLAN LAYOUT

SCALE: 1/4" = 1'-0" SHEET NO: A2.1d DWG NO: D-7817